



SPECIAL FEATURES

- **700 Peak Air Watts**
- Patented Advantek III diffusion
- 3" Commercial Lamination
- Provision for grounding to end mounting boss
- Self-hold Thermal Device for blocked inlet protection
- UL recognized, category PRGY2 (E47185)
- Suitable for 120 volt AC operation, 50 or 60 Hz

DESCRIPTION

- One stage
- 120 volts
- 5.7"/145 mm diameter
- Double ball bearings
- Single speed
- Thru-flow discharge
- Thermoset fan end bracket
- Stamped steel end bracket

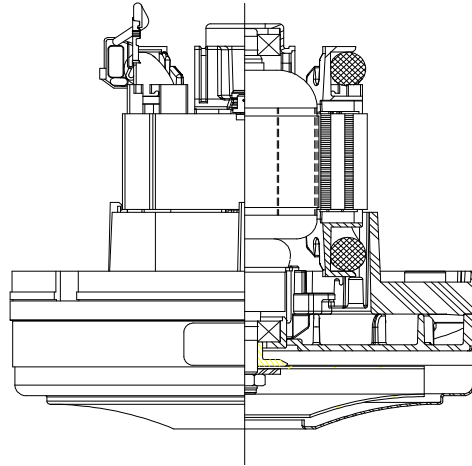

DESIGN APPLICATION

- Equipment operating in environments not requiring separation of working air from motor ventilating air
- Designed to handle clean, dry, filtered air only

Advantek III - Ultra

PEAK AIRWATTS
702
Calculated in accordance with ASTM F2105

TYPICAL MOTOR PERFORMANCE.*

(At 120 volts, 60Hz, test data is corrected to standard conditions of 29.92 Hg, 68° F.)

ASTM DATA

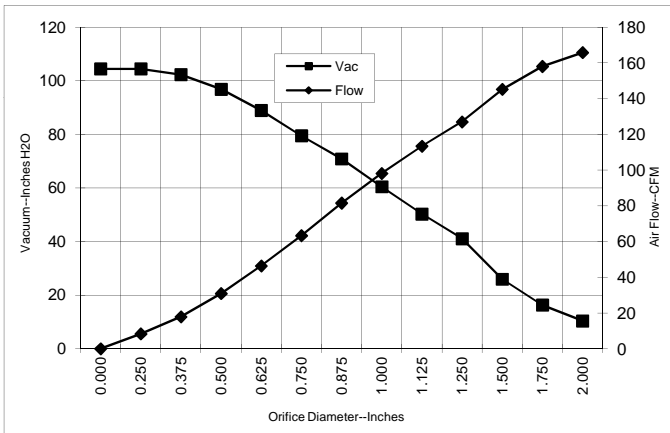

Orifice (Inches)	Amps	Watts (In)	RPM	Vac (In.H2O)	Flow (CFM)	Air Watts
2.000	14.9	1723	29977	10.4	165.8	202
1.750	15.0	1731	29933	16.3	158.1	302
1.500	14.9	1716	30029	26.0	145.2	442
1.250	14.5	1679	30360	41.1	127.0	612
1.125	14.0	1624	30648	50.3	113.4	671
1.000	13.6	1576	31137	60.5	98.1	702
0.875	12.8	1484	31861	70.9	81.6	681
0.750	11.8	1378	32634	79.5	63.3	590
0.625	10.7	1245	33984	88.9	46.4	484
0.500	9.7	1140	35434	96.8	30.9	351
0.375	8.8	1037	36741	102.3	17.9	215
0.250	7.9	935	37601	104.5	8.3	102
0.000	7.7	904	38270	104.4	0.0	0

METRIC DATA

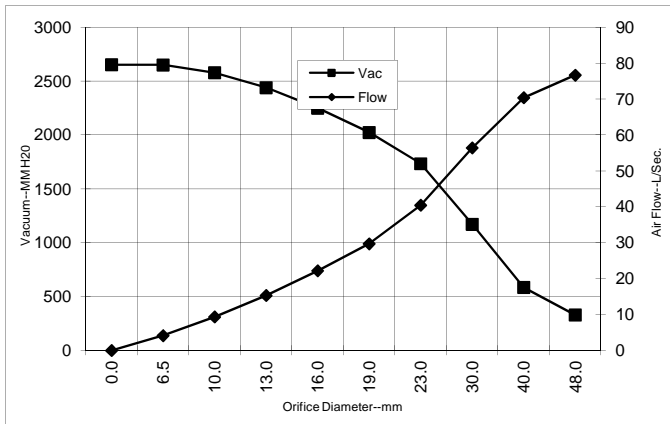

Orifice (mm)	Amps	Watts (In)	RPM	Vac (mm H2O)	Flow (L/Sec)	Air Watts
48.0	14.9	1726	29958	330	76.7	246
40.0	14.9	1721	30000	586	70.4	400
30.0	14.2	1649	30518	1172	56.4	645
23.0	13.0	1507	31680	1734	40.5	686
19.0	11.8	1375	32661	2024	29.7	588
16.0	10.7	1250	33930	2249	22.2	488
13.0	9.8	1151	35289	2440	15.3	364
10.0	8.9	1053	36545	2578	9.4	235
6.5	8.0	940	37558	2650	4.2	108
0.0	7.7	904	38270	2653	0.0	0

Note: Metric Performance data is calculated from the ASTM data above.

* Data represents performance of a typical motor sampled from a large production quantity. Individual motor data may vary due to normal manufacturing variations.

Test Specs: 120 volts	Minimum Sealed Vacuum: 104"	ORIFICE: 7/8 "	Minimum Vacuum: 70"	Maximum Watts: 1705
------------------------------	------------------------------------	-----------------------	----------------------------	----------------------------

DIMENSIONS

NOTES:

1. MODEL NUMBER, DATE OF MANUFACTURE, PLANT LOCATION CODE, AGENCY RECOGNITION CODE, INSPECTOR'S CODE, MANUFACTURER'S NAME, "US PATENT: US 6,703,754 B1", VOLTAGE AND FREQUENCY, AND CUSTOMER'S PART NO. TO APPEAR ON MOTOR.
2. MOUNTING MUST NOT RESTRICT THIS DIAMETER.
3. GROUNDING OR EARTHING PROVISIONS: USE TAB AS INDICATED FOR GROUNDING OR EARTHING. REFER TO APPROPRIATE LISTING OR REGULATORY AGENCY FOR PROPER METHOD OF GROUNDING OR EARTHING.

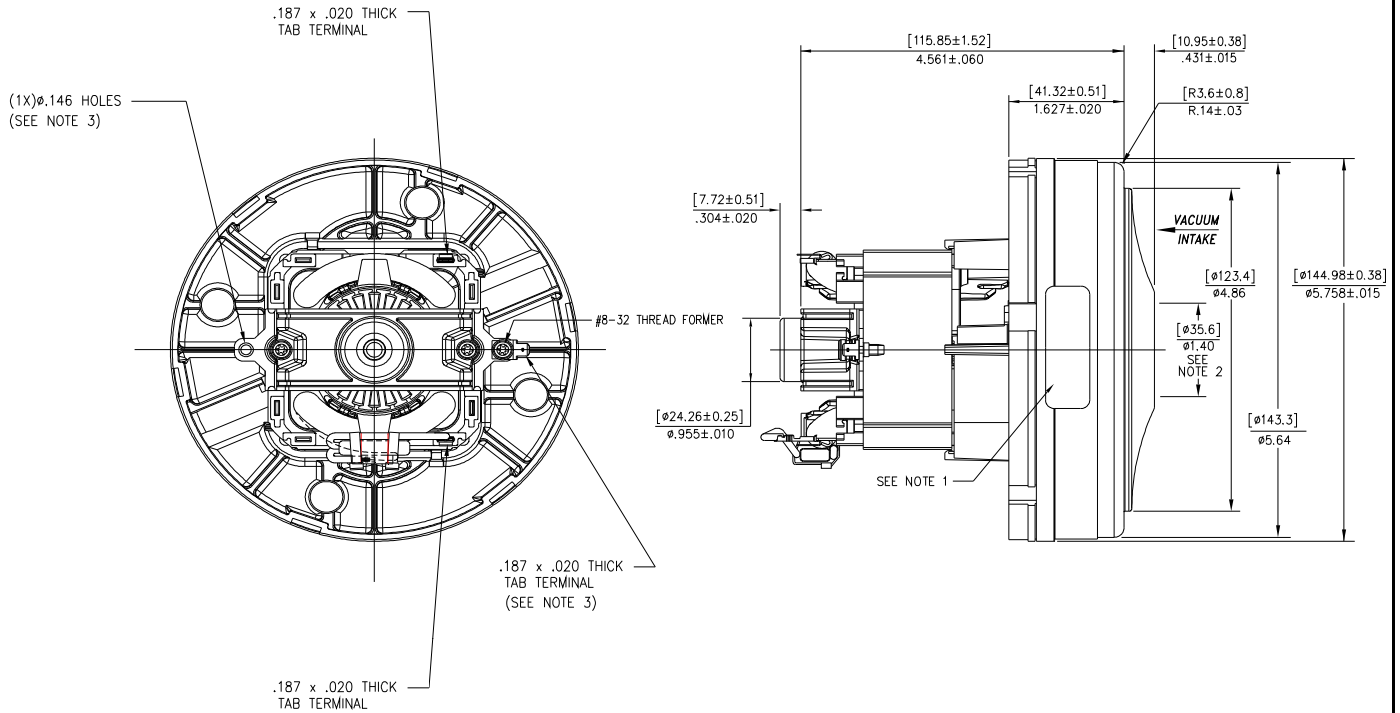

IMPORTANT NOTE: Pictorial and dimensional data are subject to change without notice. Contact factory for current revision levels.

WARNING - AMETEK Floorcare & Specialty Motors thru-flow vacuum motors must never be used in applications in which wet or moist conditions are involved, where dry chemicals or other volatile materials are present, or where airflow may be restricted or blocked. Such motors are designed to permit the vacuumed air to pass over the electrical winding to cool it. Thus any foam, liquid (including water), dry chemical, or other foreign substance coming in contact with electrical conductors could cause combustion (depending on volatility) or electrical shock. Failure to observe these precautions could result in property damage and severe personal injury, including death in extreme cases. All applications incorporating Lamb Electric motors should be submitted to Underwriters Laboratories Inc. or other appropriate organizations or agencies for testing specifically related to the safety of your equipment.

AMETEK/Floorcare & Specialty Motors
www.ametekfsm.com