



Floorcare & Specialty Motors

Model: 122225-29

SPECIAL FEATURES

- 2000+ hours life
- High efficient cooling system
- Lamb "Green Power Label"
- UL recognized, category PRGY2 (E47185)
- CSA certification pending
- Optional filtered cooling air and locked-rotor, blocked cooling air and running overload protection
- Optional new patent-pending bearing protection for wet applications.

DESCRIPTION

- 12 volts DC
- Single stage tapered fan
- 6.6" / 162 mm diameter
- Improved sound quality
- "True" tangential discharge bracket
- High-Efficiency "Galaxy" lamination
- Double ball bearings; 10mm output

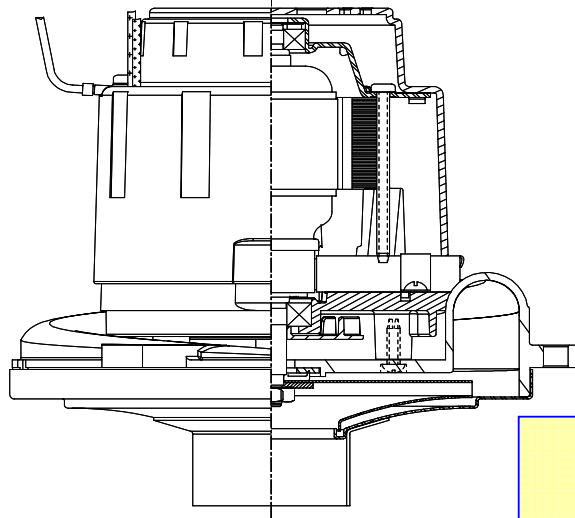

PEAK AIRWATTS

40

Calculated in accordance with ASTM F2105

DESIGN APPLICATION

- Equipment operating in environments requiring separation of working air from motor ventilating air
- Designed to handle clean, dry, filtered air only

TYPICAL MOTOR PERFORMANCE.*

(At 12 VDC, test data is corrected to standard conditions of 29.92 Hg, 68° F.)

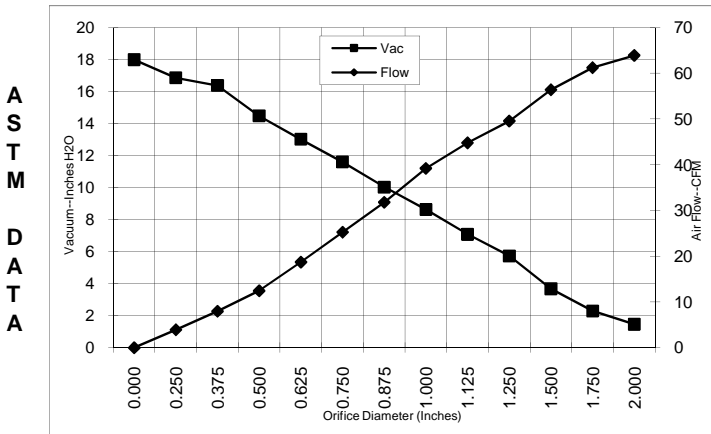

Orifice (Inches)	Amps	Watts (In)	RPM	Vac (In.H2O)	Flow (CFM)	Air Watts
2.000	13.8	166	9650	1.5	63.9	11
1.750	13.9	167	9650	2.3	61.2	17
1.500	13.9	167	9660	3.7	56.4	24
1.250	13.8	166	9690	5.7	49.6	33
1.125	13.8	166	9760	7.1	44.8	37
1.000	13.6	164	9860	8.6	39.2	40
0.875	13.4	161	10040	10.0	31.8	38
0.750	13.0	157	10330	11.6	25.3	34
0.625	12.7	153	10730	13.0	18.7	29
0.500	12.2	147	11200	14.5	12.4	21
0.375	11.7	141	11730	16.4	8.0	15
0.250	11.4	138	12090	16.9	3.9	8
0.000	11.1	134	12480	18.0	0.0	0

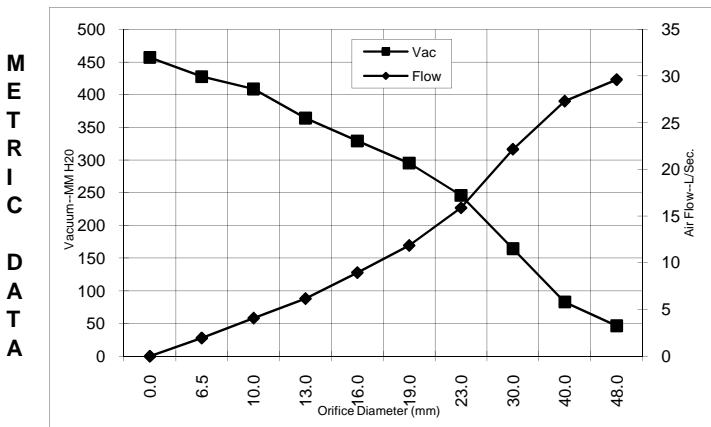

Orifice (mm)	Amps	Watts (In)	RPM	Vac (mm H2O)	Flow (L/Sec)	Air Watts
48.0	13.8	166	9650	46	29.6	13
40.0	13.9	167	9657	83	27.3	22
30.0	13.8	166	9729	164	22.1	35
23.0	13.4	162	9995	246	15.9	38
19.0	13.0	157	10338	295	11.9	34
16.0	12.7	153	10714	329	9.0	29
13.0	12.2	148	11153	364	6.2	22
10.0	11.8	142	11651	409	4.1	16
6.5	11.4	138	12072	428	2.0	8
0.0	11.1	134	12480	457	0.0	0

Note: Metric Performance data is calculated from the ASTM data above.

* Data represents performance of a typical motor sampled from a large production quantity. Individual motor data may vary due to normal manufacturing variations.

Test Specs:	120	Minimum Sealed Vacuum:	16.0	ORIFICE:	7/8"	Minimum Vacuum:	9.0	Maximum Watts:	210
--------------------	-----	-------------------------------	------	-----------------	------	------------------------	-----	-----------------------	-----

DIMENSIONS



NOTES:

1. LEADS: 18GA. STRANDED, POWER LEADS BLACK AND RED.
2. MOTOR IDENTIFICATION: MANUFACTURER'S NAME, MODEL NUMBER, VOLTAGE, FREQUENCY, INSPECTORS CODE WITH "FF" SUFFIX, DATE OF MANUFACTURE, AGENCY RECOGNITION CODE, PLANT LOCATION CODE, PATENT PENDING" AND COUNTRY OF ORIGIN.
3. MOUNTING MUST NOT RESTRICT THIS DIAMETER.
4. ALLOW [0.0026 SQ M]/4.0 SQ IN. (MIN.) FOR COOLING AIR INTAKE.
5. COOLING AIR INTAKE MUST BE SEPARATED FROM COOLING AIR EXHAUST.
6. COOLING AIR EXHAUST MUST BE SEPARATED FROM VACUUM EXHAUST.

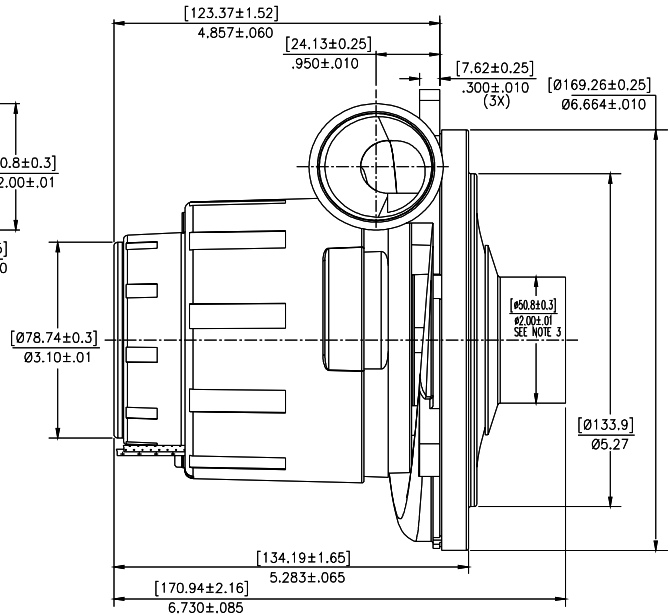
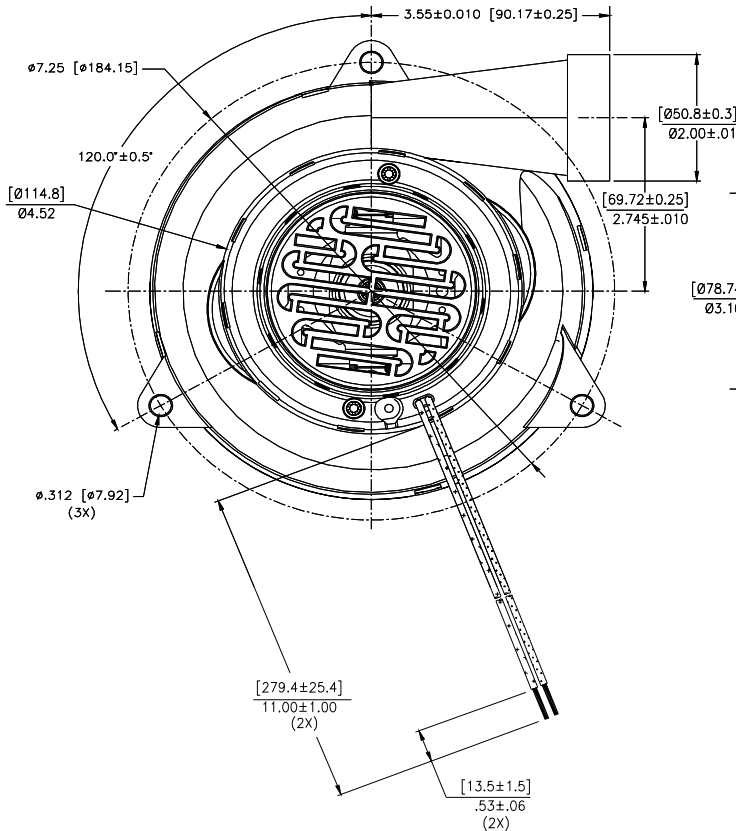

IMPORTANT NOTE: Pictorial and dimensional data are subject to change without notice. Contact factory for current revision levels.

WARNING - When using AMETEK Floorcare & Specialty Motors (F&SM) bypass motors in machines that come in contact with foam, liquid (including water), or other foreign substances, the machine must be designed and constructed to prevent those substances from reaching the fan system, motor housing, and electrical components. F&SM vacuum motors other than hazardous duty models should not be applied in machines that come in contact with dry chemicals or other volatile materials. Failure to observe these precautions could cause flashing (depending on volatility) or electrical shock which could result in property damage and severe bodily injury, including death in extreme cases. All applications incorporating F&SM motors should be submitted to appropriate organizations or agencies for testing specifically related to the safety of your equipment.

AMETEK/Floorcare & Specialty Motors
www.ametekfsm.com